

COMMANDER® SERIES



PROVEN PROTECTION FROM A COMPLETE ENVIRONMENTAL SEAL

The Commander Series offers an all-polycarbonate product with blank covers and a choice of one-or-two-hole pushbutton openings for both 22mm and 30mm hardware. These enclosures feature flush external walls, unobstructed internal walls, polymer cover screws, and a watertight polyurethane seal. They are exceptional for compact or portable control applications, or simply for use as small junction boxes.



MARKETS AND INDUSTRIES

- + Ideal for Non-Hazardous Industrial and Commercial OEM market segments
- + Manufacturing, machine building, oil and gas, portable control, and water/wastewater

INNOVATIVE FEATURES

- + Memory retaining continuous polyurethane gasket
- + 4 captive polymer screws with a lift-off cover
- + Submersible, non-corrosive, environmental design
- + High impact resistance
- + Yellow Push Button products meet EN/IEC 60947-5-5, EN/IEC 60204-1, and EN ISO 13850 requirements for emergency stop

CONSTRUCTION

Soft Edge Design

- + Rounded edges and minimal protrusions or exposed pocket areas for assembly of dust and debris

Enclosure Mounting

- + Mounting wells located under the cover/outside the gasket area

Materials

- + Box and Cover: Polycarbonate with UV inhibitors
- + Gasket: Poured polyurethane

Cover Screw Torque

- + 16in/lbs



BLANK



ONE HOLE



TWO HOLE



SAFETY YELLOW
(ONE OR TWO HOLES)

CATALOG NUMBERS AND DIMENSIONS

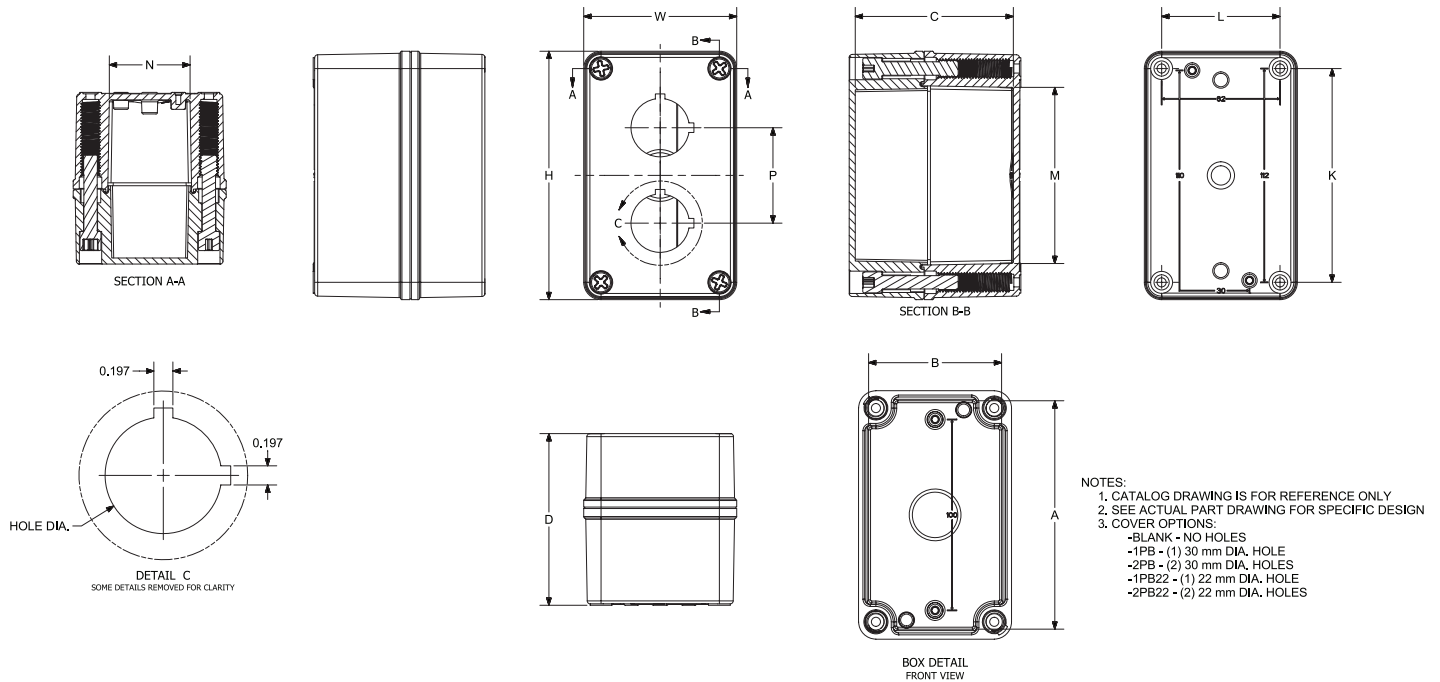

Commander Series Dimensions

| Catalog Number | Safety Yellow Catalog Number | Holes | Hole Size | Overall H x W x D | Inside A x B x C | K | L | M | N | P |
|----------------|------------------------------|-------|--------------|---------------------------------------|---------------------------------------|---------------|--------------|--------------|--------------|--------------|
| COPC432 | N/A | Blank | N/A | 4.34 x 3.16 x 2.79 (110 x 80 x 71) | 3.92 x 2.74 x 2.51 (100 x 70 x 64) | 3.62 (92) | 2.44 (62) | 2.85 (72) | 1.66 (42) | N/A |
| COPC533 | N/A | Blank | N/A | 5.12 x 3.16 x 3.54 (130 x 80 x 90) | 4.71 x 2.74 x 3.26 (120 x 70 x 83) | 4.41 (112) | 2.44 (62) | 3.63 (72) | 1.66 (42) | N/A |
| COPC1PB | YW-COPC1PB | 1 | 1.20 (30) | 4.34 x 3.16 x 2.79 (110 x 80 x 71) | 3.92 x 2.74 x 2.51 (100 x 70 x 64) | 3.62 (92) | 2.44 (62) | 2.85 (72) | 1.66 (42) | 1.20 (31) |
| COPC2PB | YW-COPC2PB | 2 | 1.20 (30) | 5.12 x 3.16 x 3.54 (130 x 80 x 90) | 4.71 x 2.74 x 3.26 (120 x 70 x 83) | 4.41 (112) | 2.44 (62) | 3.63 (72) | 1.66 (42) | 1.20 (31) |
| COPC1PB22 | YW-COPC1PB22 | 1 | 0.89 (22) | 4.34 x 3.16 x 2.79 (110 x 80 x 71) | 3.92 x 2.74 x 2.51 (100 x 70 x 64) | 3.62 (92) | 2.44 (62) | 2.85 (72) | 1.66 (42) | 0.89 (23) |
| COPC2PB22 | YW-COPC2PB22 | 2 | 0.89 (22) | 5.12 x 3.16 x 3.54 (130 x 80 x 90) | 4.71 x 2.74 x 3.26 (120 x 70 x 83) | 4.41 (112) | 2.44 (62) | 3.63 (72) | 1.66 (42) | 0.89 (23) |

All measurements are in inches; items in parentheses are in millimeters.